

0202 INJECTION PUMP

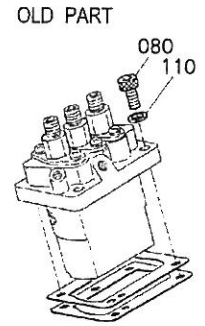
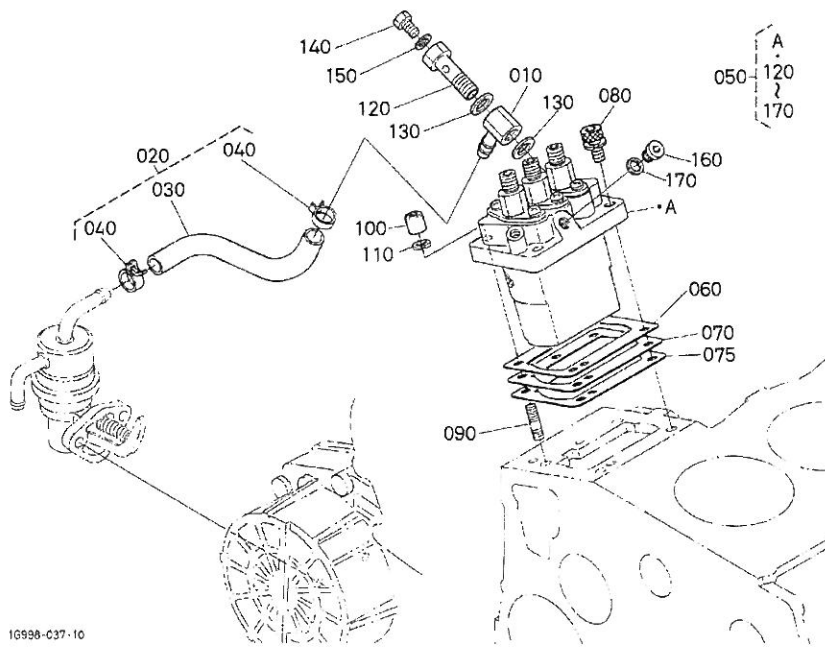

A: D905-E2BB-REP-1

REF. No.	PART No.	PART NAME	Q' TY/S. No.		I. C.	REMARKS
			A	B		
010	16241-9569-0	JOINT, EYE	1	-		
020	16032-4201-0	ASSY TUBE, FUEL	1	-		
030	09661-80075	TUBE, FUEL	1	-		
040	14911-4275-0	CLIP, PIPE	2	-		
050	16030-5101-0	ASSY PUMP, INJECTION	1	-		
060	1G700-5220-0	SHIM, INJECTION PUMP	1	-		Ø 175mm
060	16006-5209-2	SHIM, INJECTION PUMP	1	-		Ø 200mm
060	16006-5211-2	SHIM, INJECTION PUMP	1	-		Ø 250mm
070	16006-5212-2	SHIM, INJECTION PUMP	1	-		Ø 300mm
075	1G700-5216-0	SHIM, INJECTION PUMP	1	-		Ø 350mm
080	01311-10620	BOLT, HEX-SOC-HD	2 ≤=8BZ999	-		#
080	16871-9106-0	BOLT, HEX-SOC-HD	2 ≥=8C0001	-	←	#
090	15841-9150-0	STUD	2	-		
100	15841-9232-0	NUT	2	-		
110	04512-60060	WASHER, SPRING	4 ≤=8BZ999	-		#
110	04512-60060	WASHER, SPRING	2 ≥=8C0001	-		#
120	16030-5132-0	BOLT, JOINT	1	-		
130	15841-9665-0	GASKET	2	-		
140	15841-5135-0	SCREW	1	-		
150	15841-9666-0	GASKET	1	-		
160	16030-9601-0	PLUG	1	-		
170	15861-9665-0	GASKET	1	-		

↔ Interchangeable; ≠ not interchangeable; ← new for old; → old for new

