

REV	DATE	CHANGE DESCRIPTION	MOD BY	CK1	CK2
A3	06/07/2007	FIXED DETAIL ERROR	ZS	RJH	HM

124118-01  
8.499 DIA  
(6) .406 DIA HOLES  
EQ. SPACED ON 7.283 B.C.

123207-02  
SPLINE DATA  
13 TEETH  
16/32 D.P.  
30° P.A.  
.885 MAJOR  
SAE "B"

S.A.E. A PUMP MOUNT  
3.25" PILOT  
(4) 3/8-16 TAPPED HOLES  
EQ. SPACED ON A 4.19 B.C.

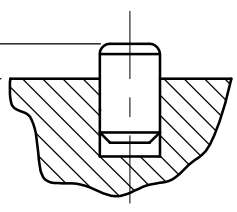
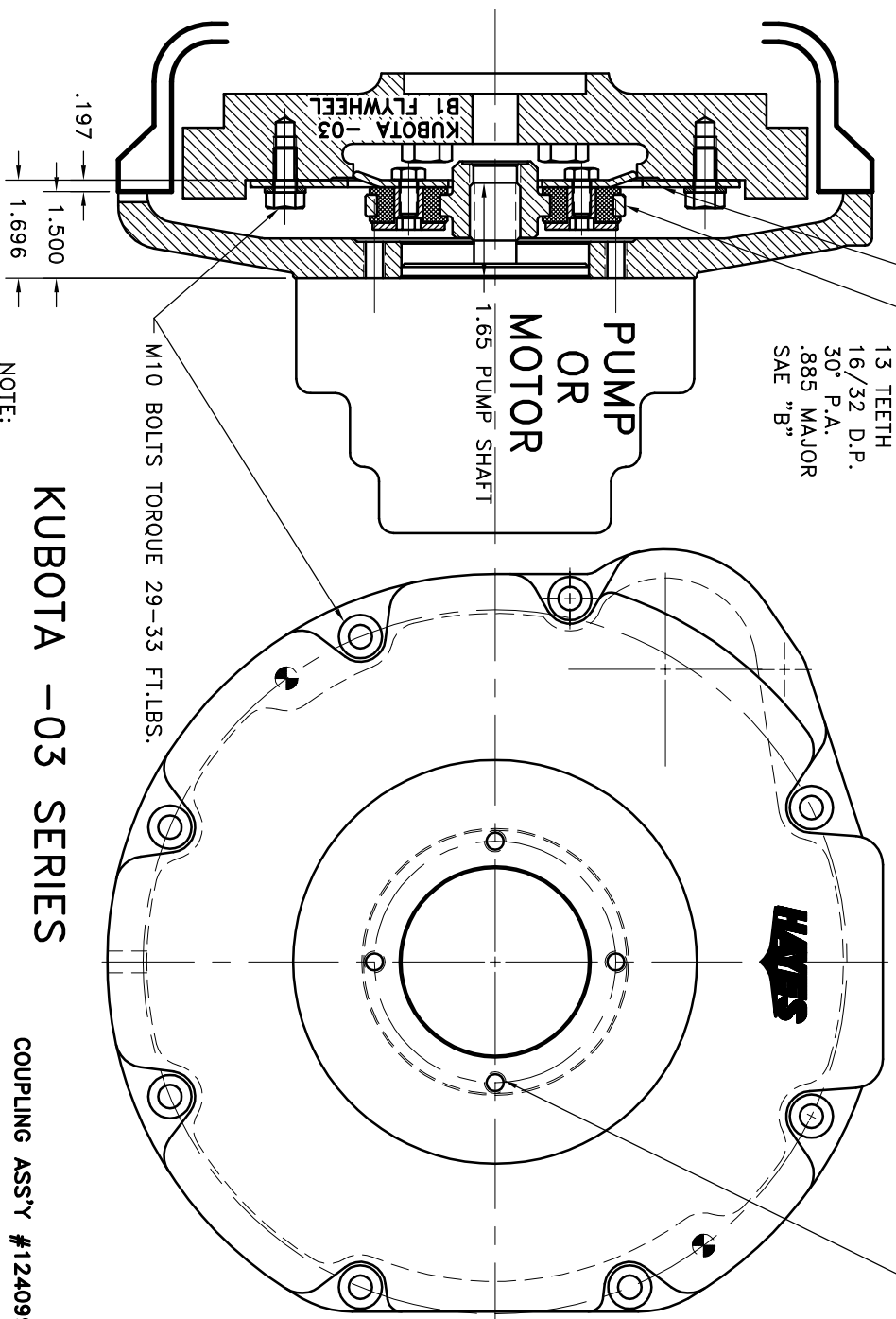

NOTE: INSTALL 2 DOWEL PINS

ASS'Y WORKS WITH  
FLYWHEELS: C-1(16414-25111) &  
C-4(19629-25113)  
HOUSINGS: D-9(19004-04611) &  
D-8(19077-04611)

NOTE:  
1. HOUSING FOR KUBOTA ENGINES D1403-B,  
D1703-B, V1903-B, AND V2203-B.

2. USE FURNISHED COUPLING GREASE ON BOTH  
MALE AND FEMALE SPLINE.

3. DOWEL PIN MUST BE PRESSED IN SO THERE IS  
ONLY .230-.225 OF DOWEL STICKING OUT OF  
HOUSING.

## KUBOTA -03 SERIES

### COUPLING ASS'Y #124099

QTY	DESCRIPTION	PART NUMBER	DET.	DO NOT SCALE DRAWING	SYMBOLS
1	BOLT KIT	933113	10		FLATNESS
2	M10 x 20mm DOWEL PINS	933023-10	9		PERPENDICULARITY
1	HOUSING	801912	7		PARALLELISM
1	GREASE	801912	7		CONCENTRICITY
1	HUBBARD PLUG	HP-1125-S-32	6		FORM PRECISION
6	5/16-24 x 5/8" HHB	HX100	5		ROUNDNESS
6	THREADED BUSHING	123729-01	4		CIRCULAR RUN OUT
6	NEOPRENE INSERT	H52500	3		TOTAL RUN OUT
1	COUPLING HUB [1.3 16/32\3.000]	123207-02	2		CYLINDRICITY
1	FLYWHEEL PLATE [SPEC.: 3.000]	124118-01	1		FINISH



KUBOTA -03 SERIES HOUSING & FLYWHEEL COUPLING ASS'Y

DATE	DRAWN BY	DATE	DRAWING NO.
04-04-03	SELING	04-04-03	933129
SCALE	CHECKED BY	SCALE	933129
	RJH		OF
			REV.

THIS DRAWING IS THE PROPERTY OF HAYES MFG. INC. AND IS LOANED TO YOU FOR THE CONDITION OF WORK AND NOT TO BE REPRODUCED OR COPIED IN ANY MANNER WITHOUT THE WRITTEN PERMISSION OF HAYES MFG. INC. IT SHALL BE USED AS A MEANS OF REFERENCE TO WORK FURNISHED BY THIS COMPANY ONLY, AND IS NOT TO BE SUBMITTED TO OUTSIDE PARTIES FOR EXAMINATION WITHOUT OUR CONSENT.