

# 010200 PISTON AND CRANKSHAFT

## PISTON Y CIGUENAL

### PISTON ET VILEBREQUIN

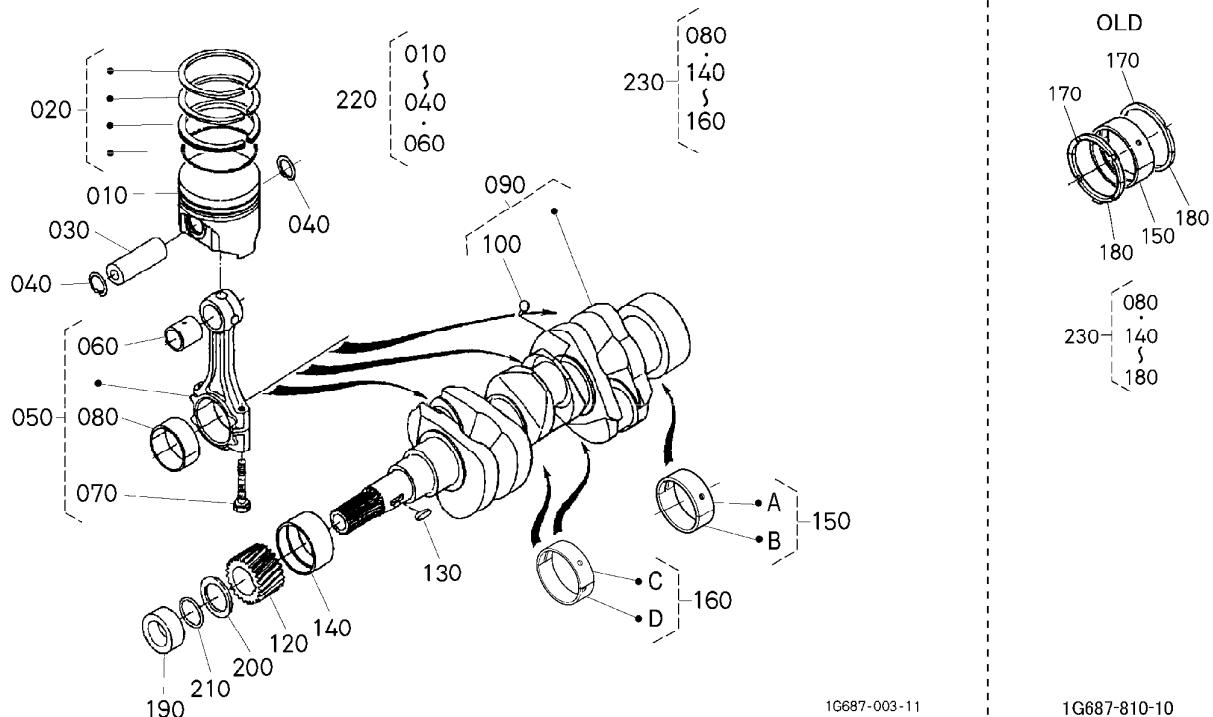

A: D902-E3B-KEA-1

REF.No. No DE REF POS.No.	PART No. No. REF. REFERENCE	PART NAME	DESCRIPCION	DESIGNATION	Q'TY/S.No. CANTIDAD/No. DE SERIE	I.C. I/C	REMARKS NOTA REMARQUES
					A	I.C.	
140	1G460-2391-0	METAL,CRANKSHAFT	METAL,CIGUENAL	COUSSINET DE VILEBR.	1 <=BDZ999		#-0.20mm
140	1G460-2391-2	METAL,CRANKSHAFT	METAL,CIGUENAL	COUSSINET DE VILEBR.	1 >=BE0001	←	#-0.20mm
140	1G460-2392-0	METAL,CRANKSHAFT	METAL,CIGUENAL	COUSSINET DE VILEBR.	1 <=BDZ999		#-0.40mm
140	1G460-2392-2	METAL,CRANKSHAFT	METAL,CIGUENAL	COUSSINET DE VILEBR.	1 >=BE0001	←	#-0.40mm
150	1G460-2382-0	METAL,ASSY(2,CRANKSH	CONJ.METAL,CGUNL	ENS.COUSSINET DE VI.	1 <=BDZ999		#STD/SET
150	1G460-2382-2	METAL,ASSY(2,CRANKSH	CONJ.METAL,CGUNL	ENS.COUSSINET DE VI.	1 >=BE0001	←	#STD/SET
150	1G460-2382-3	METAL,ASSY(2,CRANKSH	CONJ.METAL,CGUNL	ENS.COUSSINET DE VI.	1 >=GE0001	←	#STD/SET
150	1G460-2393-0	METAL,ASSY(2-02,CRAN	CONJ.METAL,CGUNL	ENS.COUSSINET DE VI.	1 <=BDZ999		#-0.20mm/SET
150	1G460-2393-3	METAL,ASSY,CRANKSHAF	CONJ.METAL,CGUNL	ENS.COUSSINET DE VI.	1 >=BE0001	←	#-0.20mm/SET
150	1G460-2395-0	METAL,ASSY(2-04,CRAN	CONJ.METAL,CGUNL	ENS.COUSSINET DE VI.	1 <=BDZ999		#-0.40mm/SET
150	1G460-2395-3	METAL,ASSY(2-04,CRAN	CONJ.METAL,CGUNL	ENS.COUSSINET DE VI.	1 >=BE0001	←	#-0.40mm/SET
160	1G460-2383-0	METAL,ASSY(3,CRANKSH	CONJ.METAL,CGUNL	ENS.COUSSINET DE VI.	2 <=BDZ999		#STD/SET
160	1G460-2383-3	METAL,ASSY(3,CRANKSH	CONJ.METAL,CGUNL	ENS.COUSSINET DE VI.	2 >=BE0001	←	#STD/SET
160	1G460-2394-0	METAL,ASSY(3-02,CRAN	CONJ.METAL,CGUNL	ENS.COUSSINET DE VI.	2 <=BDZ999		#-0.20mm/SET
160	1G460-2394-3	METAL,ASSY(3-02,CRAN	CONJ.METAL,CGUNL	ENS.COUSSINET DE VI.	2 >=BE0001	←	#-0.20mm/SET
160	1G460-2396-0	METAL,ASSY(3-04,CRAN	CONJ.METAL,CGUNL	ENS.COUSSINET DE VI.	2 <=BDZ999		#-0.40mm/SET
160	1G460-2396-3	METAL,ASSY(3-04,CRAN	CONJ.METAL,CGUNL	ENS.COUSSINET DE VI.	2 >=BE0001	←	#-0.40mm/SET
170	15261-2353-0	METAL, SIDE	METAL,LADO	COUSSINET DE LATERAL	2 <=BDZ999		#STD
170	15261-2353-3	METAL, SIDE	METAL,LADO	COUSSINET DE LATERAL	2 >=BE0001	←	#STD
170	15261-2353-3	METAL, SIDE	METAL,LADO	COUSSINET DE LATERAL	2 <=GFZ999		#STD
170	15261-2395-0	METAL, SIDE	METAL,LADO	COUSSINET DE LATERAL	2		+0.20mm
170	15261-2395-2	METAL, SIDE	METAL,LADO	COUSSINET DE LATERAL	2	↔	#+0.20mm
170	15261-2395-3	METAL, SIDE	METAL,LADO	COUSSINET DE LATERAL	2 >=BE0001	←	#+0.20mm
170	15261-2395-3	METAL, SIDE	METAL,LADO	COUSSINET DE LATERAL	2 <=GFZ999		#+0.20mm
170	15261-2396-0	METAL, SIDE	METAL,LADO	COUSSINET DE LATERAL	2 <=BDZ999		#+0.40mm
170	15261-2396-3	METAL, SIDE	METAL,LADO	COUSSINET DE LATERAL	2 >=BE0001	←	#+0.40mm
170	15261-2396-3	METAL, SIDE	METAL,LADO	COUSSINET DE LATERAL	2 <=GFZ999		#+0.40mm
180	15261-2354-3	METAL, SIDE	METAL,LADO	COUSSINET DE LATERAL	2 <=BDZ999		#STD
180	15261-2354-4	METAL, SIDE	METAL,LADO	COUSSINET DE LATERAL	2 >=BE0001	←	#STD
180	15261-2354-4	METAL, SIDE	METAL,LADO	COUSSINET DE LATERAL	2 <=GFZ999		#STD

↔ Interchangeable; ≠ not Interchangeable; ← new for old; → old for new